

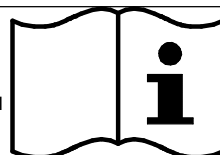

D - Montageanleitung GB - Assembly instructions NL - Handleiding voor de montage  
 PL - Instrukcj montazu TR - Montaj talimatu RU - Инструкция по монтажу  
 RO - Instructiuni de montaj IT - Istruzioni di montaggio FR - Notice de montage  
 SK - Navod na montaz CZ - Montazni navod HU - Szerelesi utmutato HR - Upute za montažu  
 SI - Navodila za montažo BG - Инструкция за сглобяване



Name-Naam-Nazwa-Isim-Nom-Nume-Nome-Nom-Názov-Název-Nev-Ime-Име

# FIDSCHI 3F. FIDSCHI 2 3F.

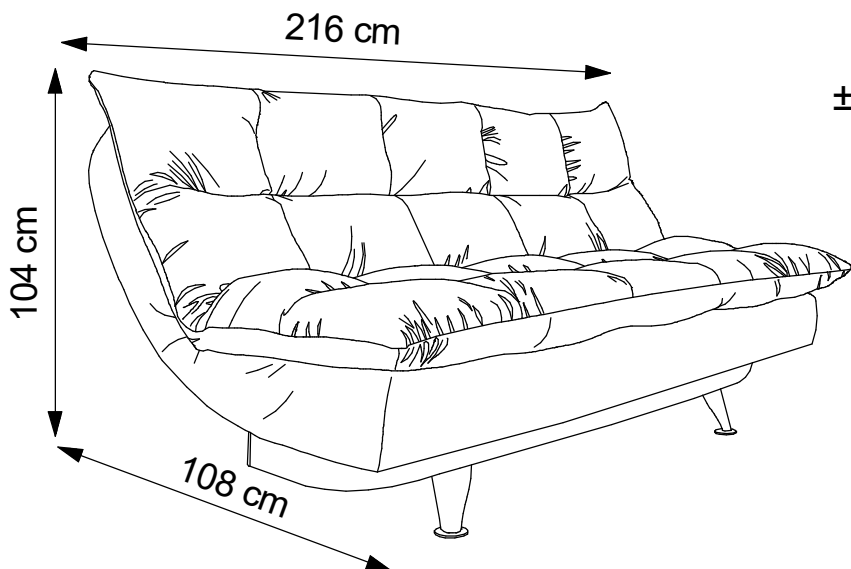
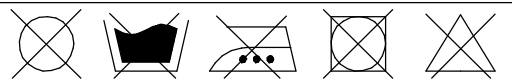

! ± 2 cm

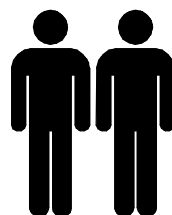

			PCS	
140	58	210	x1	1/1

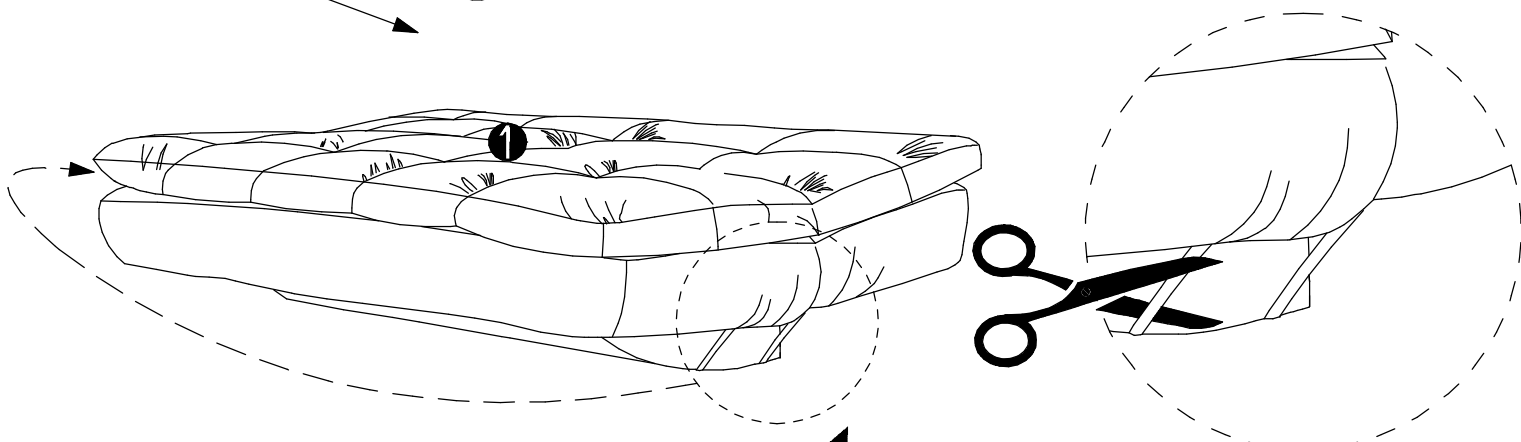

	/1		
	x2		6x30
E1		E2	x8

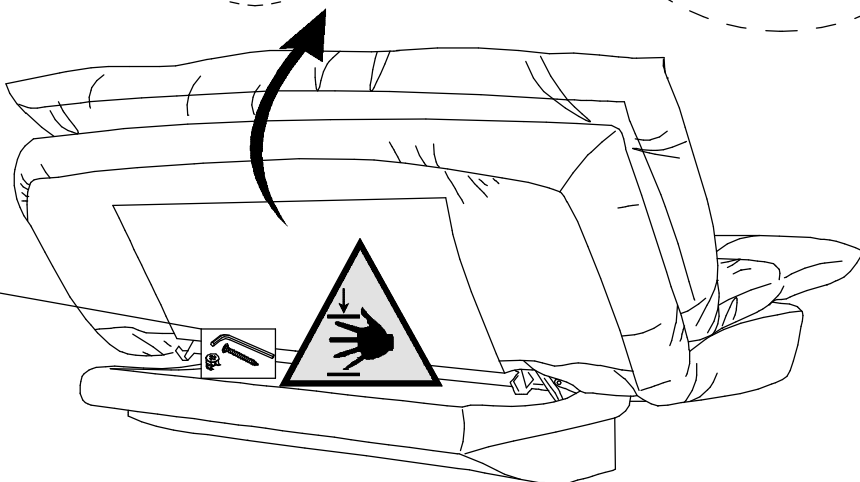

Service-Dienstverlening-Serwis-Servis-Сервисная служба-Serviciu-Servizio-Sluzby-Szrviz-Storitev-Обслуживание

Typ-Type-Tip-Tipi-Tastati-Tipo-Tipus

E1	<input type="checkbox"/>
E2	<input type="checkbox"/>
G1	<input type="checkbox"/>
G2	<input type="checkbox"/>
	<input type="checkbox"/>
	<input type="checkbox"/>
	<input type="checkbox"/>
	<input type="checkbox"/>

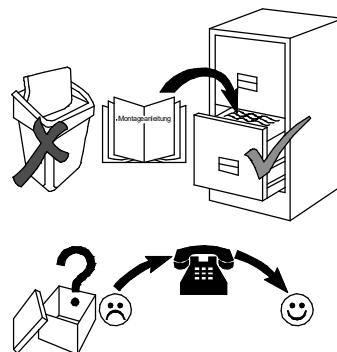

Serien-/Chargen-Nr.-



D - Montageanleitung GB - Assembly instructions NL - Handleiding voor de montage  
 PL - Instrukcij montazu TR - Montaj talimatu RU - Инструкция по монтажу  
 RO - Instructiuni de montaj IT - Istruzioni di montaggio FR - Notice de montage  
 SK - Navod na monta CZ - Monta ni navod HU - Szerelési utmutato HR - Upute za montažu  
 SI - Navodila za montažo BG - Инструкция заглобяване

Name-Naam-Nazwa-Isim-Nom-Nume-Nome-Nom-Názov-Název-Nev-Ime-Име

# FIDSCHI 3F. FIDSCHI 2 3F.

	x 2		x 8
--	-----	--	-----

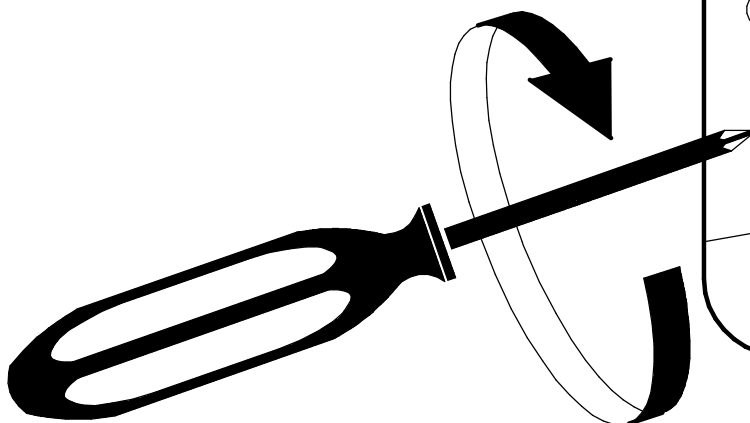
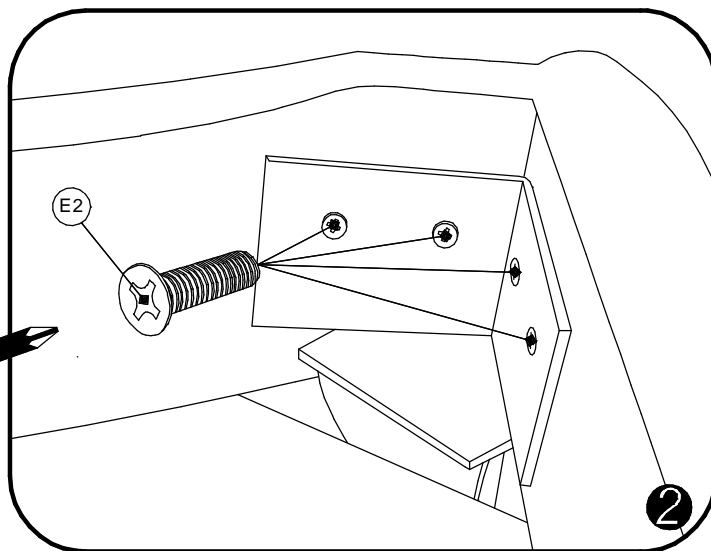
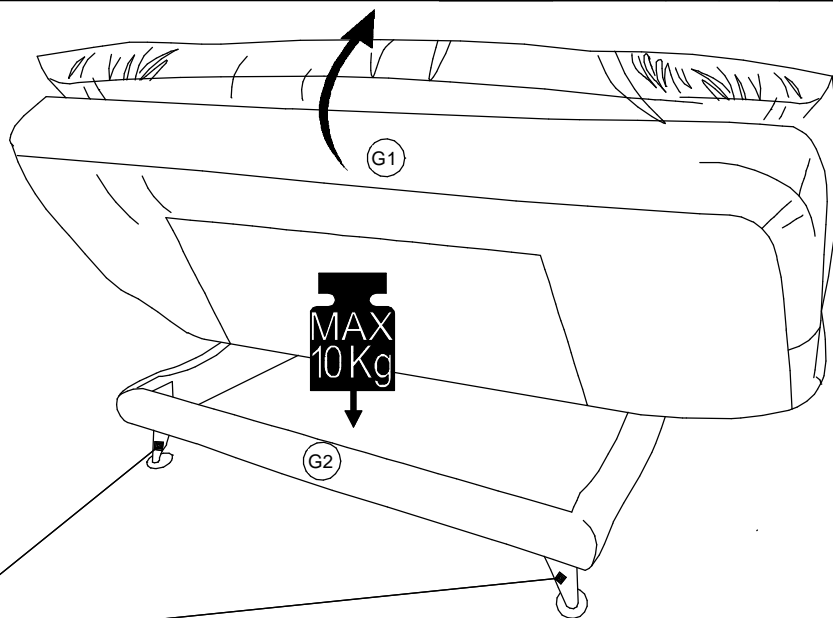
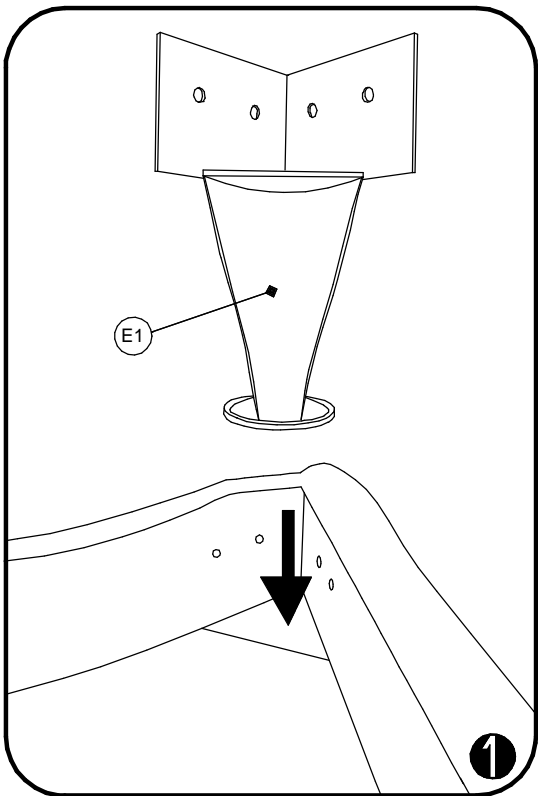

Service-Dienstverlening-Serwis-Servis-Сервисная служба-Serviciu-Servizio-Služby-Szrviz-Storitev-Обслуживание

Typ-Type-Tip-Tipi-Tastati-Tipo-Tipus

E1	<input type="checkbox"/>
E2	<input type="checkbox"/>
G1	<input type="checkbox"/>
G2	<input type="checkbox"/>
	<input type="checkbox"/>
	<input type="checkbox"/>
	<input type="checkbox"/>

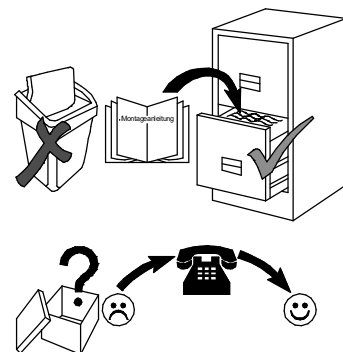

Serien-/Chargen-Nr.-



D - Montageanleitung GB - Assembly instructions NL - Handleiding voor de montage  
 PL - Instrukcij montazu TR - Montaj talimatu RU - Инструкция по монтажу  
 RO - Instructiuni de montaj IT - Istruzioni di montaggio FR - Notice de montage  
 SK - Navod na monta CZ - Monta ni navod HU - Szerelesi utmutato HR - Upute za montažu  
 SI - Navodila za montažo BG - Инструкция за сглобяване

Name-Naam-Nazwa-Isim-Nom-Nume-Nome-Nom-Názov-Název-Nev-Ime-Име

# FIDSCHI 3F. FIDSCHI 2 3F.

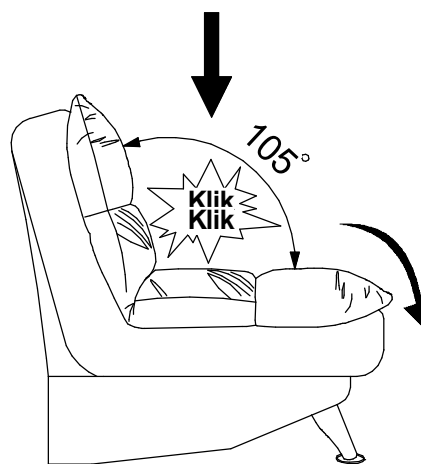
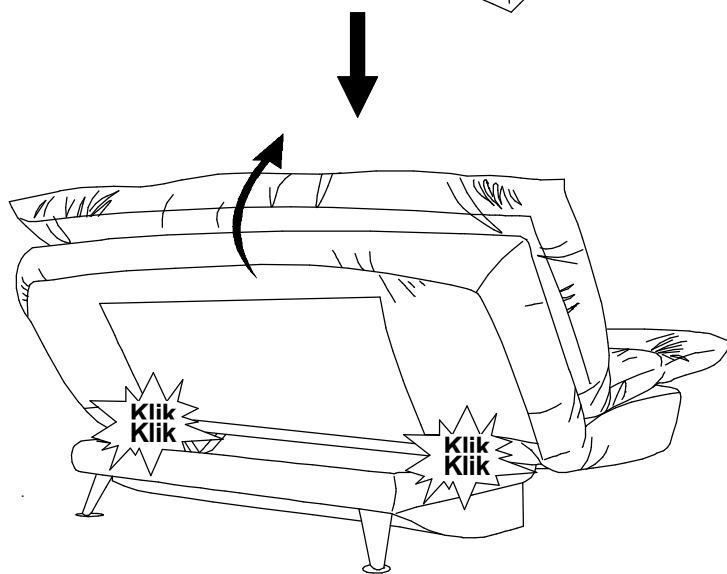
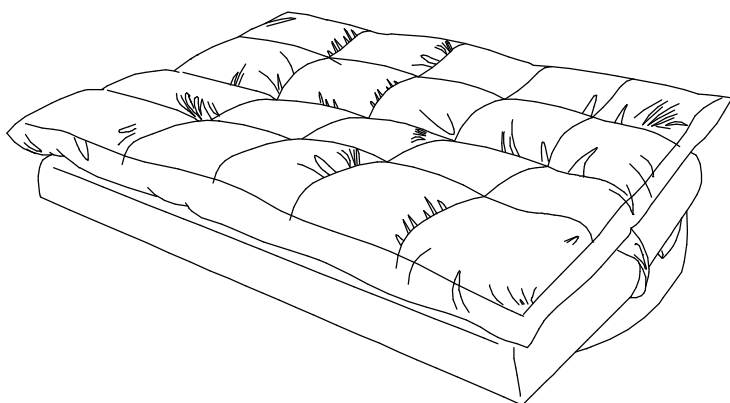
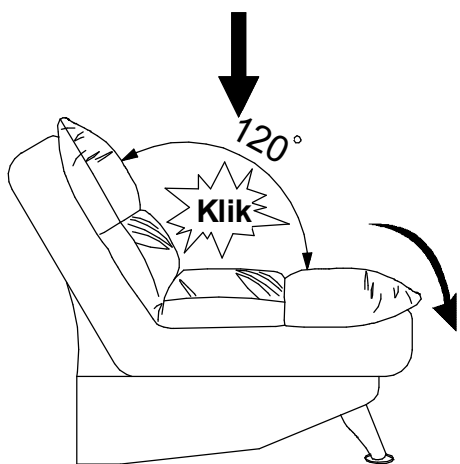
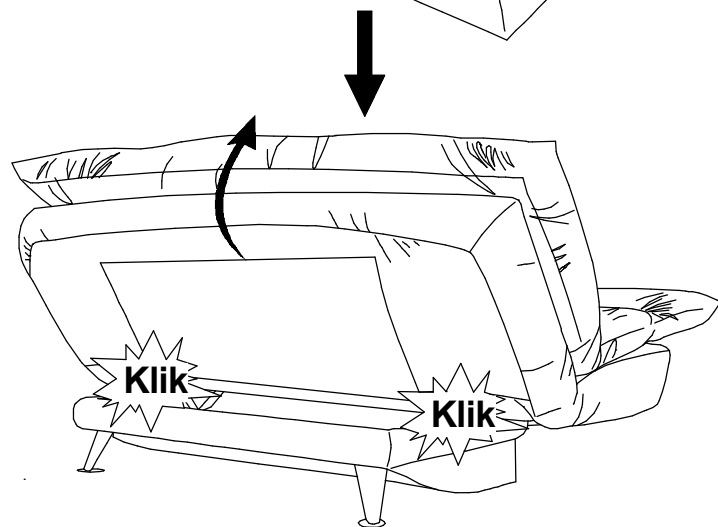
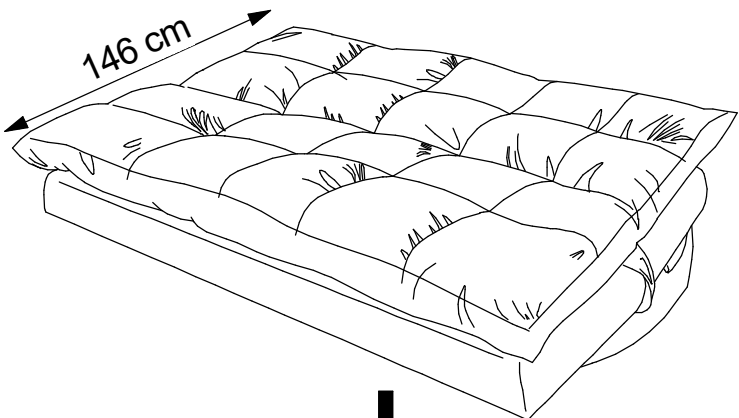

Service-Dienstverlening-Serwis-Servis-Сервисная служба-Serviciu-Servizio-Služby-Szrviz-Storitev-Обслуживание

Typ-Type-Tip-Tipi-Tastati-Tipo-Tipus

E1	<input type="checkbox"/>
E2	<input type="checkbox"/>
G1	<input type="checkbox"/>
G2	<input type="checkbox"/>
	<input type="checkbox"/>
	<input type="checkbox"/>
	<input type="checkbox"/>
	<input type="checkbox"/>

Serien-/Chargen-Nr.-

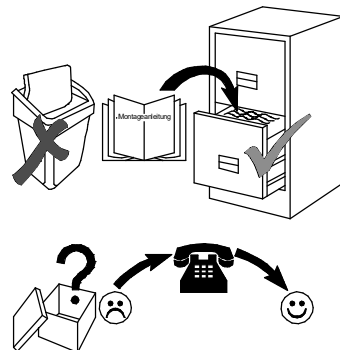



D - Montageanleitung GB - Assembly instructions NL - Handleiding voor de montage  
 PL - Instrukcj montazu TR - Montaj talimatu RU - Инструкция по монтажу  
 RO - Instructiuni de montaj IT - Istruzioni di montaggio FR - Notice de montage  
 SK - Navod na monta CZ - Monta ni navod HU - Szerelesí utmutató HR - Upute za montažu  
 SI - Navodila za montažo BG - Инструкция заглобяване

Name-Naam-Nazwa-Isim-Nom-Nume-Nome-Nom-Názov-Název-Nev-Ime-Име

# FIDSCHI 3F. FIDSCHI 2 3F.

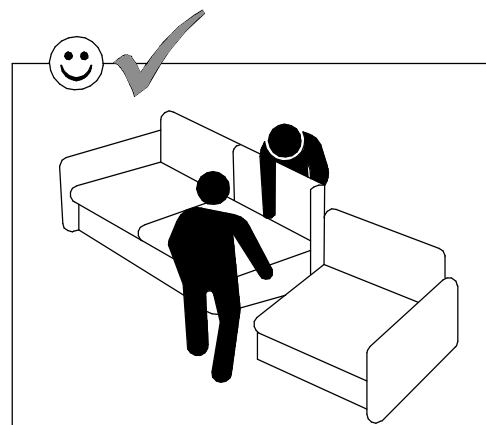
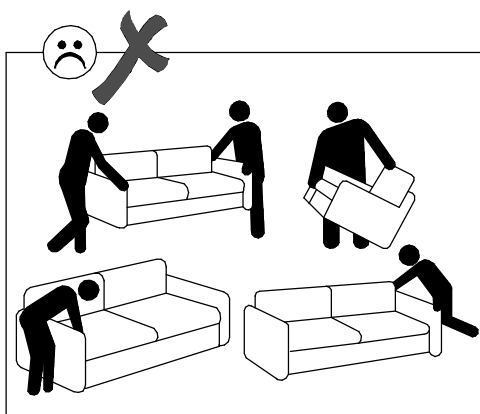
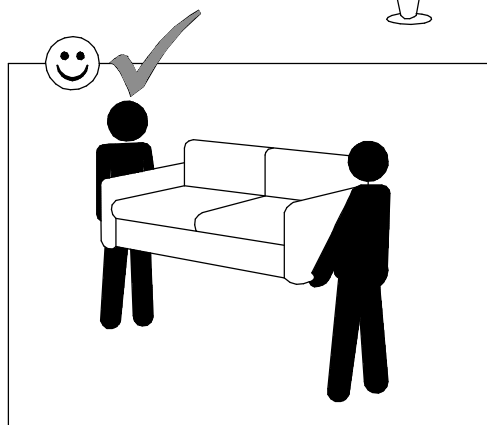
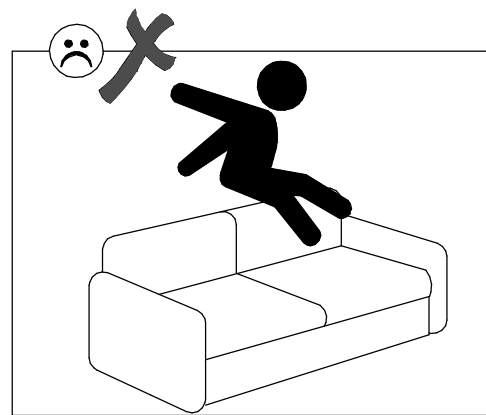
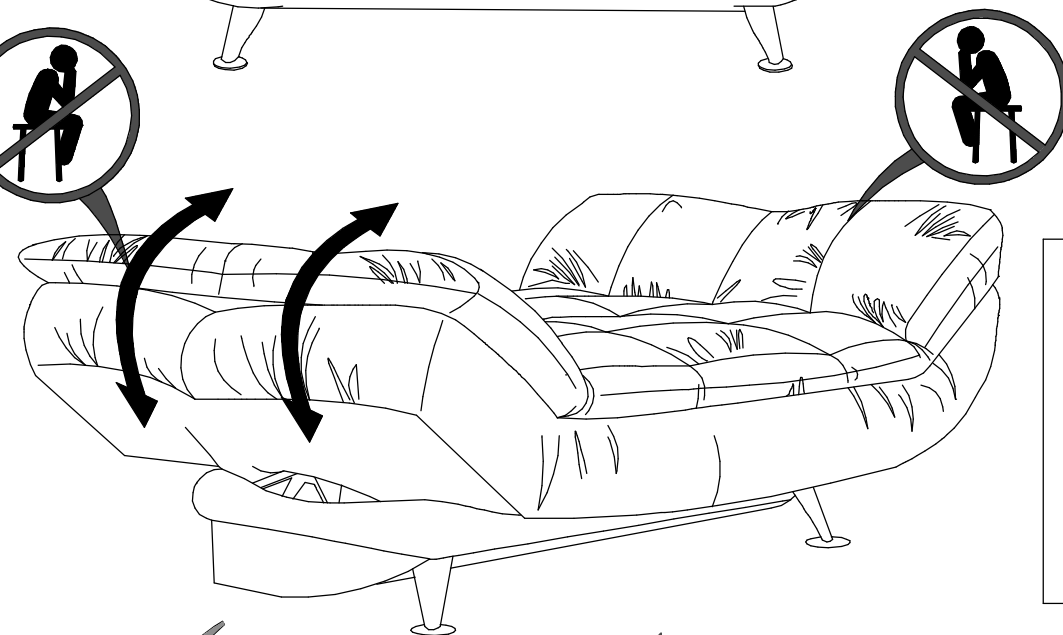
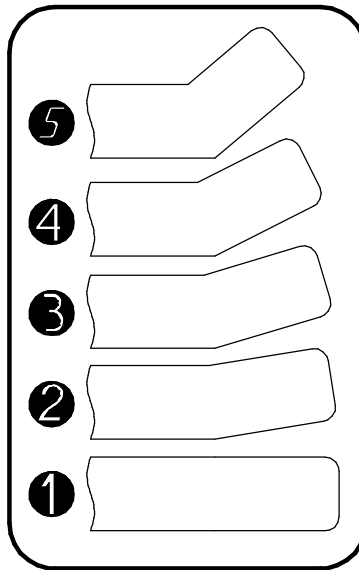
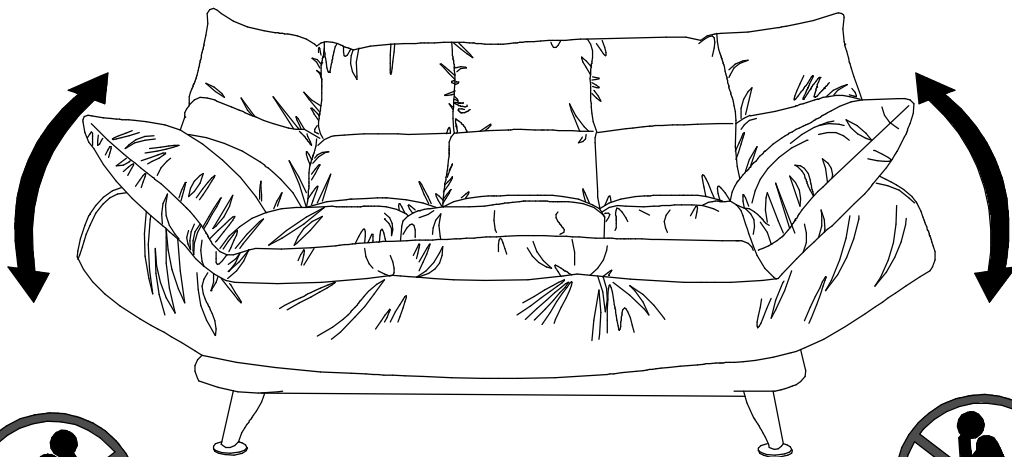

Service-Dienstverlening-Serwis-Servis-Сервисная служба-Serviciu-Servizio-Služby-Szrviz-Storitev-Обслуживание

Typ-Type-Tip-Tipi-Tastati-Tipo-Tipus

E1	<input type="checkbox"/>
E2	<input type="checkbox"/>
G1	<input type="checkbox"/>
G2	<input type="checkbox"/>
	<input type="checkbox"/>
	<input type="checkbox"/>
	<input type="checkbox"/>
	<input type="checkbox"/>
	<input type="checkbox"/>
	<input type="checkbox"/>

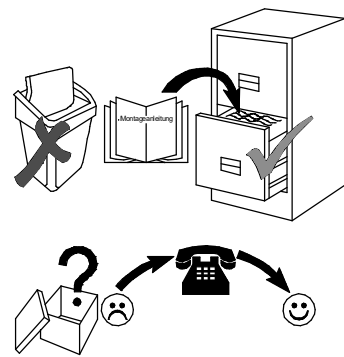

Serien-/Chargen-Nr.-



D - Montageanleitung GB - Assembly instructions NL - Handleiding voor de montage  
 PL - Instrukcij montazu TR - Montaj talimatu RU - Инструкция по монтажу  
 RO - Instructiuni de montaj IT - Istruzioni di montaggio FR - Notice de montage  
 SK - Navod na monta CZ - Montážní návod HU - Szerelési utmutató HR - Upute za montažu  
 SI - Navodila za montažo BG - Инструкция за сглобяване

Name-Naam-Nazwa-Isim-Nom-Nume-Nome-Nom-Názov-Název-Nev-Ime-Име

# FIDSCHI 3F. FIDSCHI 2 3F.

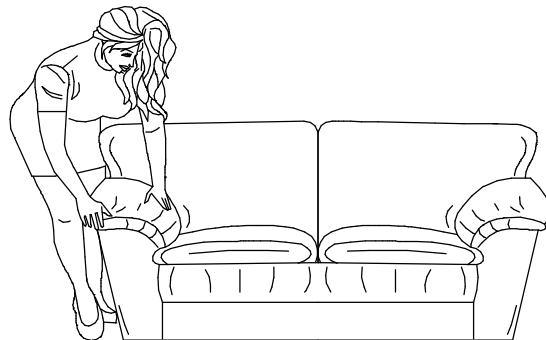
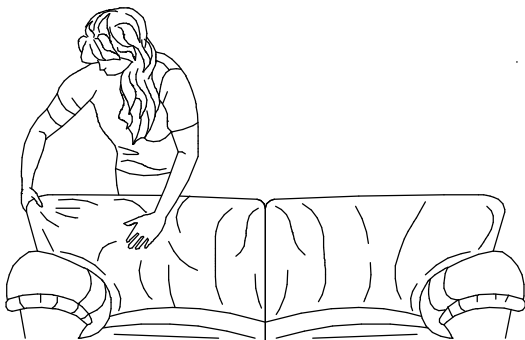
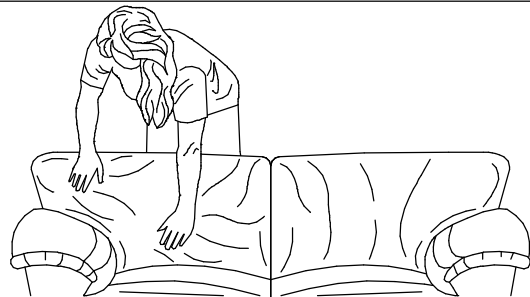
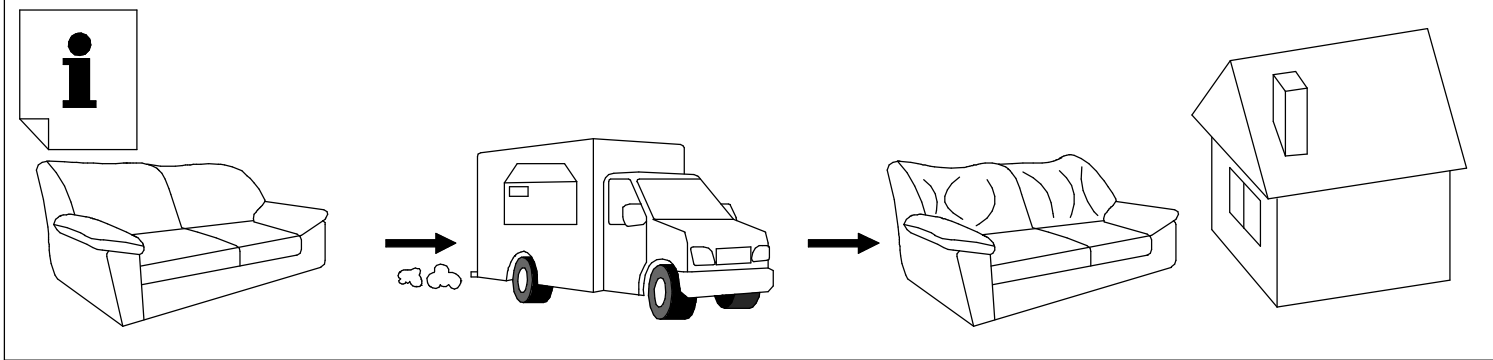
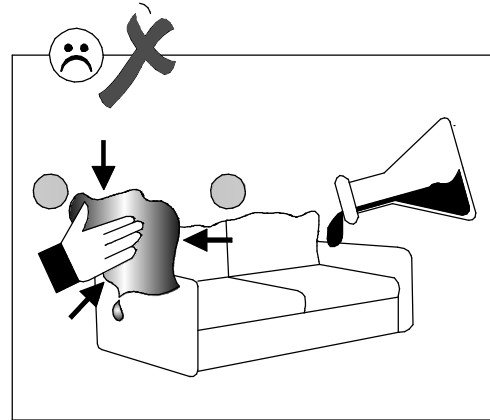
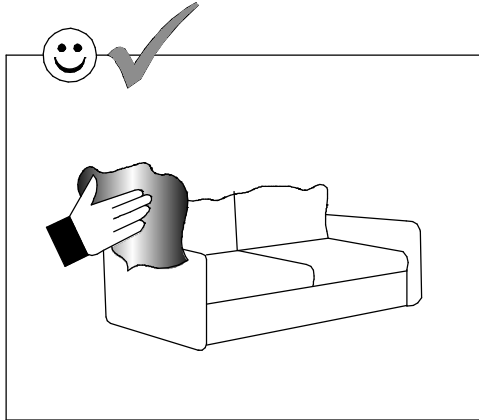
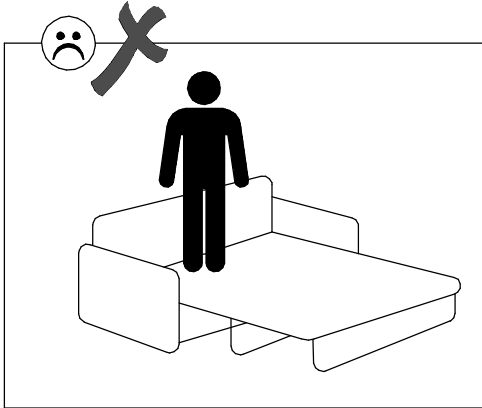

Service-Dienstverlening-Serwis-Servis-Сервисная служба-Serviciu-Servizio-Služby-Szrviz-Storitev-Обслуживание

Typ-Type-Tip-Tipi-Tastati-Tipo-Tipus

E1	<input type="checkbox"/>
E2	<input type="checkbox"/>
G1	<input type="checkbox"/>
G2	<input type="checkbox"/>
	<input type="checkbox"/>
	<input type="checkbox"/>
	<input type="checkbox"/>
	<input type="checkbox"/>

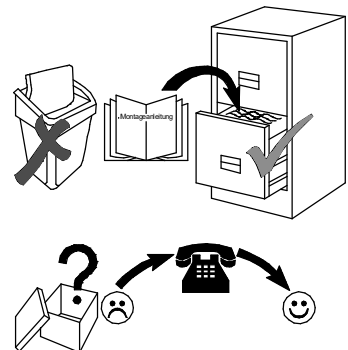

Serien-/Chargen-Nr.-